



## ACCESSORY SETUP INSTRUCTION

### WINDSHIELD ASSEMBLY -- PN 9DS#-805000-6000

VALID FOR: MY2020 and Newer CFORCE 600 / 625 & CFORCE 600 TOURING / 625 TOURING

**BEFORE YOU BEGIN:** Read and understand the instructions before starting any work. Make sure that all parts are ready and that you have all the tools required for assembly.

**NOTE:** CFMOTO shall not be liable for any damage caused by incorrect assembly. CFMOTO recommends that all original accessories be assembled by an authorized CFMOTO dealer.

Before assembly, park the vehicle on a flat surface, put the transmission gear into Park (P) and turn off the key switch.

**Zhejiang CFMOTO Power Co., Ltd.** All rights reserved. Reproduction of this document, even in part, as well as copying of all kinds, is permitted only with the express written permission of the copyright owner.

### MEANING OF SYMBOLS



- Indicates information with more details or tips.



- Indicates information of warning or danger.

### PARTS LIST:

S/N	PART NAME	PART NUMBER	QTY.	REMARK
1	WINDSHIELD	6NTA-201401-80000	1	
2	LEFT WINDSHIELD BRACKET	9DS#-805002-6000	1	
3	RIGHT WINDSHIELD BRACKET	9DS#-805003-6000	1	
4	INNER HEX SCREW M6x20	30102-060020870	4	
5	NUT	30206-060570	4	
6	WASHER	30303-060070	4	
7	WASHER 6x20x1.5	30309-060870	4	
8	TANK PANEL RUBBER DAMPER	A000-040302	4	
9	FRONT WINDSHIELD	9DS#-805000-6000	1	

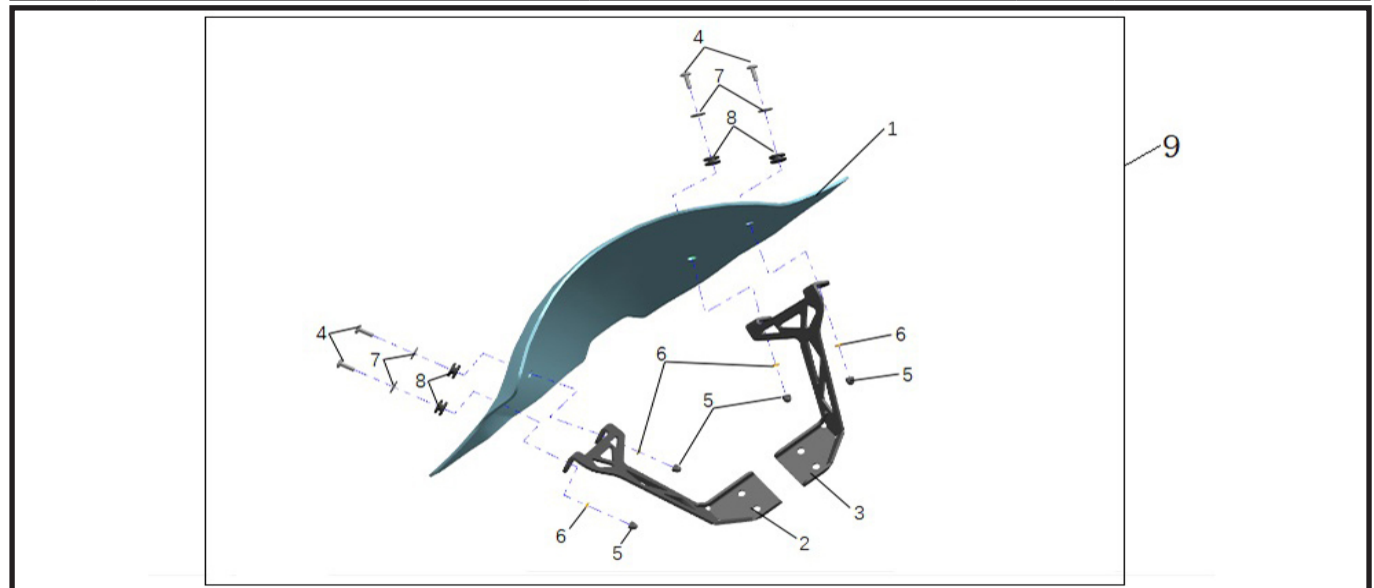

### TOOL LIST:

Item	Description	QTY.	REMARK
1	TORQUE WRENCH	1	Recommended Tools
2	OPEN-ENDED WRENCH 8-10mm	1	
3	13mm SOCKET	1	
4	4mm ALLEN WRENCH	1	
5	MARKER	1	
6	PROTECTIVE GLOVES	1	

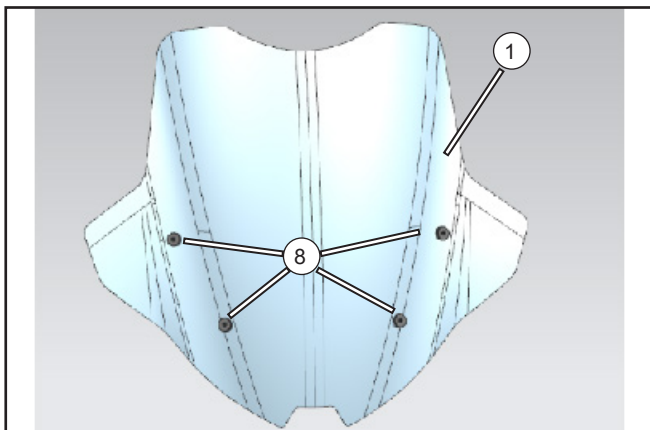

// Install the rubber dampers (8) into the windshield (1) mounting holes.

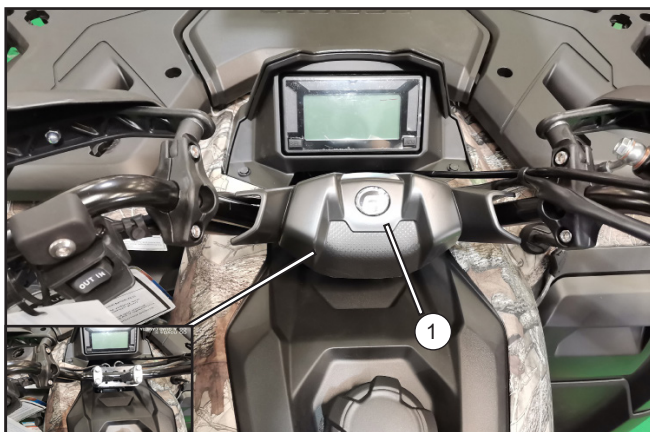

// Remove the handlebar upper guard (1) by pulling upward.



// Remove the handlebar clamp bolts (1).

**i** Mark the angle of the handlebar in the clamps with a marker before removing the bolts to facilitate control of the installation angle during subsequent reassembly.



// Install the left (2) and right (3) windshield brackets under the handlebar clamps (1). Reinstall the clamp bolts and torque evenly to specification.

BOLT	M8	30006-080055810	22-30N.m
------	----	-----------------	----------

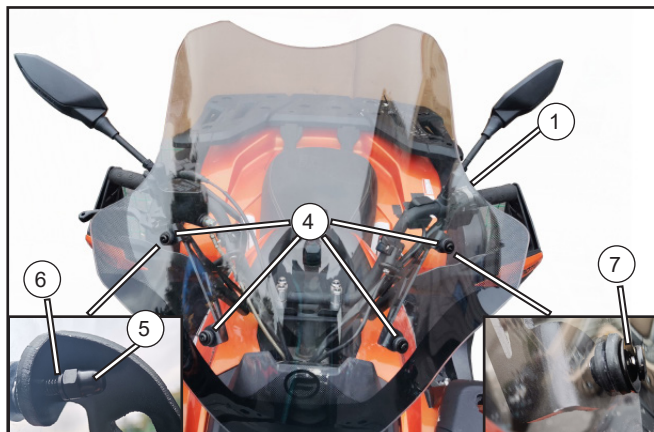

- // Fasten the windshield (1) to the brackets using the inner hex screws (4), 6x20 washers (7), washers (6) and nuts (5). Torque the fasteners to specification.
- // Install the handle bar upper guard.

BOLT	M6x20	30102-060020870	8-12N.m
WASHER	6x20x1.5	30309-060870	/
WASHER	/	30303-060070	/
NUT	M8	30206-060570	/